



## Features

- Low air consumption reduces air usage and cost.
- Horizontal or vertical gauge scales available to suite master panel layout.
- Mounting brackets attached for easy installation into master panel.

## Operating Principle

Model MPL-70 Mini-panel Loading Stations transmit and monitor a pressure signal for pneumatic instrumentation. This loading station is ideally suited for applications with limited space.

The Model MPL-70 includes a Model 70B Pneumatic Subminiature Regulator and a mini-strip gage to set and read pressure at the panel.

Turn the adjusting knob in the loading station panel in a clockwise direction to increase output pressure or in a counter-clockwise direction to decrease output pressure.

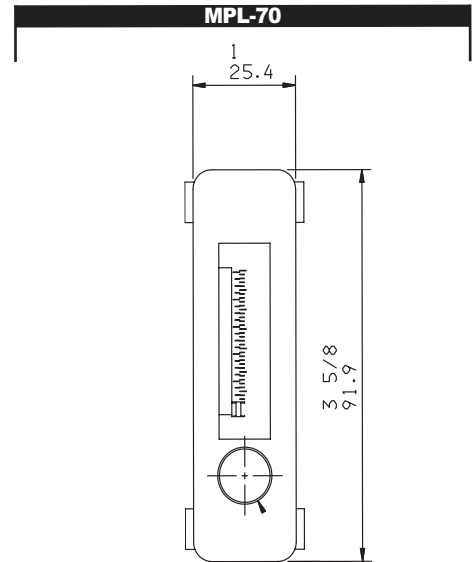

- MPL fits cutout size 7/8" (+1/8, -0) x 3-3/8" (+1/8, -0)

Inlet & outlet connections are barbed fittings for 1/8" I.D. tubing.

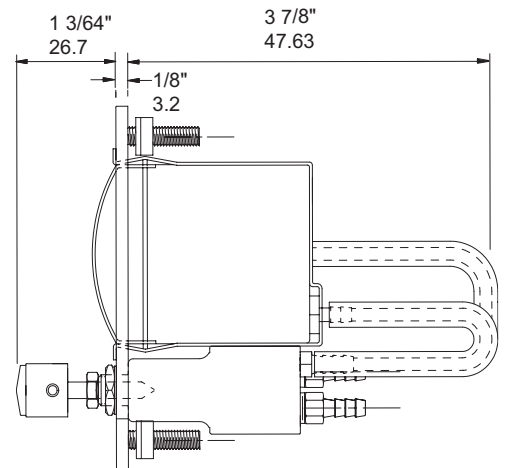

# MPL-70 Mini Panel Loading Station

## Specifications

### Minimum Supply Pressure

50 psig, [3.5 BAR], (350 kPa)

### Maximum Operating Supply Pressure

250 psig, [17 BAR], (1700 kPa)

### Flow Capacity

2.5 SCFM (4.25 m<sup>3</sup>/HR) @ 100 psig, [7.0 BAR], (700 kPa) supply, 30 psig, [2.0 BAR], (200 kPa) setpoint

### Supply Pressure Effect

0.05 psig, [.003 BAR], (.35 kPa) change in output for 5 psig, [.35 BAR], (35 kPa) change in supply pressure

### Air Consumption

0.05 SCFM (.085 m<sup>3</sup>/HR) on dead-end service; 20 psig, [1.5 BAR], (150 kPa) supply; 9 psig, [.6 BAR], (60 kPa) output

### Ambient Temperature

...-40°F to +160°F,  
(-40°C to 71°C)

### Materials of Construction

Regulator .....Brass, Viton (Fluorocarbon), Fiberglass

Three-way Valve .....Brass, Steel,

Gage .....Zinc Plated Steel, Brass

Hose .....Plastic

## Service Information

A Service Kit is available for the Model 70B Regulator, refer to the *Fairchild Model 70B Installation, Operation and Maintenance Instructions*, IS-1000070B.

## Catalog Information

### Catalog Number

--	--	--	--	--	--

### Panel

without Transfer Function

MPL
-----

### Regulator

Model 70 .....

70
----

### Gage Type

Leave Blank for MPL .....

--

### Gage Type

Plain Vertical .....

PV
----

Plain Horizontal .....

PH
----

Receiver Vertical <sup>2</sup> (Graduated 0-100%) .....

RV
----

Receiver Horizontal <sup>2</sup> (Graduated 0-100%) .....

RH
----

### Regulator Range <sup>3</sup>

15 psig	[1.0 BAR]	(100 kPa)	.....	15
30 psig	[2.0 BAR]	(200 kPa)	.....	30
60 psig	[4.0 BAR]	(400 kPa)	.....	60
100 psig	[7.0 BAR]	(700 kPa)	.....	100

### Gage Range

15 psig	[1.0 BAR]	(100 kPa)	.....	15
30 psig	[2.0 BAR]	(200 kPa)	.....	30
60 psig	[4.0 BAR]	(400 kPa)	.....	60
100 psig	[7.0 BAR]	(700 kPa)	.....	100

<sup>2</sup> 0-100% scale for 3-15 psig, [0.2-1.0 BAR], (20-100 kPa) range.

<sup>3</sup> To avoid gage damage, the regulator range should be equal to or less than the gage range.